

VACANT LAND DISCLOSURE REPORT

DISCLAIMER

THIS DISCLOSURE REPORT CONCERNS THE REAL PROPERTY LOCATED AT _____
L2 CSM 16272 Castleton Crossing IN THE Village
(CITY) (VILLAGE) (TOWN) OF Windsor, COUNTY OF _____
STATE OF WISCONSIN.

THIS REPORT IS A DISCLOSURE OF THE CONDITION OF THAT PROPERTY IN COMPLIANCE WITH SECTION 709.02 OF THE WISCONSIN STATUTES AS OF August (MONTH) 12 (DAY), 2024 (YEAR). IT IS NOT A WARRANTY OF ANY KIND BY THE OWNER OR ANY AGENTS REPRESENTING ANY PARTY IN THIS TRANSACTION AND IS NOT A SUBSTITUTE FOR ANY INSPECTIONS OR WARRANTIES THAT THE PARTIES MAY WISH TO OBTAIN.

A buyer who does not receive a fully completed copy of this report within 10 days after the acceptance of the contract of sale or option contract for the above-described real property has the right to rescind that contract (Wis. Stat. s. 709.02), provided the owner is required to provide this report under Wisconsin Statutes chapter 709.

NOTICE TO PARTIES REGARDING ADVICE OR INSPECTIONS

Real estate licensees may not provide advice or opinions concerning whether or not an item is a defect for the purposes of this report or concerning the legal rights or obligations of parties to a transaction. The parties may wish to obtain professional advice or inspections of the property and to include appropriate provisions in a contract between them with respect to any advice, inspections, defects, or warranties.

A. OWNER'S INFORMATION

A1. In this form, "aware" means the "owner(s)" have notice or knowledge.

A2. In this form, "defect" means a condition that would have a significant adverse effect on the value of the property; that would significantly impair the health or safety of future occupants of the property; or that if not repaired, removed, or replaced would significantly shorten or adversely affect the expected normal life of the premises.

A3. In this form, "owner" means the person or persons, entity, or organization that owns the above-described real property. An "owner" who transfers real estate that does not include any buildings is required to complete this report.

Exceptions: An "owner" who is a personal representative, trustee, conservator, or fiduciary appointed by or subject to supervision by a court, and who has never occupied the property transferred is not required to complete this report. An "owner" who transfers property that has not been inhabited or who transfers property in a manner that is exempt from the real estate transfer fee is not required to complete this report. (Wis. Stat. s. 709.01)

A4. The owner represents that to the best of the owner's knowledge, the responses to the following questions have been accurately checked as "yes," "no," or "not applicable (N/A)" to the property being sold. If the owner responds to any question with "yes," the owner shall provide, in the additional information area of this form, an explanation of the reason why the response to the question is "yes."

A5. If the transfer is of a condominium unit, the property to which this form applies is the condominium unit, the common elements of the condominium, and any limited common elements that may be used only by the owner of the condominium unit being transferred.

A6. The owner discloses the following information with the knowledge that, even though this is not a warranty, prospective buyers may rely on this information in deciding whether and on what terms to purchase the property. The owner hereby authorizes the owner's agents and the agents of any prospective buyer to provide a copy of this report, and to disclose any information in the report, to any person in connection with any actual or anticipated sale of the property.

CAUTION: The lists of defects following each question below are examples only and are not the only defects that may properly be disclosed in response to each respective question.

B. ENVIRONMENTAL

- | | YES | NO | N/A |
|--|--------------------------|-------------------------------------|--------------------------|
| B1. Are you aware of a material violation of an environmental rule or other rule or agreement regulating the use of the property? | <input type="checkbox"/> | <input checked="" type="checkbox"/> | <input type="checkbox"/> |
| B2. Are you aware of a defect caused by unsafe concentrations of, or unsafe conditions relating to, radon, radium in water supplies, high voltage electric (100 KV or greater) or steel natural gas transmission lines located on but not directly serving the property, lead in soil, or other potentially hazardous or toxic substances on the property? | <input type="checkbox"/> | <input checked="" type="checkbox"/> | <input type="checkbox"/> |
| B3. Are you aware of the manufacture of methamphetamine or other hazardous or toxic substances on the property? | <input type="checkbox"/> | <input checked="" type="checkbox"/> | <input type="checkbox"/> |
| B4. Are you aware of subsoil conditions that would significantly increase the cost of development, including, but not limited to, subsurface foundations or waste material; any type of fill; dumpsites where pesticides, herbicides, fertilizer, or other toxic or hazardous materials or containers for these materials were disposed of in violation of manufacturer or government guidelines or other laws regulating such disposal; high groundwater; adverse soil conditions, such as low load-bearing capacity, earth or soil movement, settling, upheavals, or slides; excessive rocks or rock formations; or other soil problems? | <input type="checkbox"/> | <input checked="" type="checkbox"/> | <input type="checkbox"/> |
| B5. Are you aware of a defect caused by unsafe concentrations of, unsafe conditions relating to, or the storage of hazardous or toxic substances on neighboring properties? | <input type="checkbox"/> | <input checked="" type="checkbox"/> | <input type="checkbox"/> |
| B6. Are you aware of brownfields (abandoned, idled, or underused land that may be subject to environmental contamination) or other contaminated land on the property, or that contaminated soils on the property have been cleaned up under the Petroleum Environmental Cleanup Fund Act (PECFA), a Wisconsin Department of Natural Resources (DNR) remedial or cleanup program, the DATCP Agricultural Chemical Cleanup Program, or other similar program? | <input type="checkbox"/> | <input checked="" type="checkbox"/> | <input type="checkbox"/> |

B7. Explanation of "yes" responses

C. WELLS, SEPTIC SYSTEMS, STORAGE TANKS

- | | YES | NO | N/A |
|--|--------------------------|-------------------------------------|--------------------------|
| C1. Are you aware of underground storage tanks presently or previously on the property for storage of flammable or combustible liquids, including, but not limited to, gasoline or heating oil? (If "yes," the owner, by law, may have to register the tanks with the Wisconsin Department of Agriculture, Trade and Consumer Protection at P.O. Box 8911, Madison, Wisconsin, 53708, whether the tanks are in use or not. Wisconsin Department of Agriculture, Trade and Consumer Protection regulations may require the closure or removal of unused tanks.) | <input type="checkbox"/> | <input checked="" type="checkbox"/> | <input type="checkbox"/> |
| C2. Are you aware of defects in the underground or aboveground fuel storage tanks on or previously located on the property? Defects in underground or aboveground fuel storage tanks may include items such as abandoned tanks not closed in conformance with applicable local, state, and federal law; leaking; corrosion; or failure to meet operating standards. | <input type="checkbox"/> | <input checked="" type="checkbox"/> | <input type="checkbox"/> |
| C3. Are you aware of defects in a well on the property or a well that serves the property, including unsafe well water due to contaminants such as coliform, nitrates, or atrazine, or any out-of-service wells or cisterns that are required to be abandoned (see s. NR 812.26, Wis. Adm. Code) but that are not closed or abandoned according to applicable regulations? | <input type="checkbox"/> | <input checked="" type="checkbox"/> | <input type="checkbox"/> |
| C4. Are you aware of a joint well serving this property? | <input type="checkbox"/> | <input checked="" type="checkbox"/> | <input type="checkbox"/> |
| C5. Are you aware of a defect relating to a joint well serving this property? | <input type="checkbox"/> | <input checked="" type="checkbox"/> | <input type="checkbox"/> |
| C6. Are you aware of defects in any septic system or other private sanitary disposal system on the property or any out-of-service septic system that serves the property and that is not closed or abandoned according to applicable regulations? | <input type="checkbox"/> | <input checked="" type="checkbox"/> | <input type="checkbox"/> |

C7. Explanation of "yes" responses

D. TAXES, SPECIAL ASSESSMENTS, PERMITS, ETC.

	YES	NO	N/A
D1. Have you received notice of a property tax increase, other than normal annual increases, or are you aware of a pending property tax reassessment?	<input type="checkbox"/>	<input checked="" type="checkbox"/>	<input type="checkbox"/>
D2. Are you aware of pending special assessments?	<input type="checkbox"/>	<input checked="" type="checkbox"/>	<input type="checkbox"/>
D3. Are you aware of the property being located within a special purpose district, such as a drainage district, that has the authority to impose assessments against the real property located within the district?	<input type="checkbox"/>	<input checked="" type="checkbox"/>	<input type="checkbox"/>
D4. Are you aware of any land division involving the property for which required state or local permits were not obtained?	<input type="checkbox"/>	<input checked="" type="checkbox"/>	<input type="checkbox"/>
D5. Are you aware of impact fees or another condition or occurrence that would significantly increase development costs or reduce the value of the property to a reasonable person with knowledge of the nature and scope of the condition or occurrence?	<input type="checkbox"/>	<input checked="" type="checkbox"/>	<input type="checkbox"/>
D6. Are you aware of proposed, planned, or commenced public improvements or public construction projects that may result in special assessments or that may otherwise materially affect the property <u>or the present use of the property?</u>	<input type="checkbox"/>	<input checked="" type="checkbox"/>	<input type="checkbox"/>
D7. Explanation of "yes" responses	<hr/> <hr/> <hr/> <hr/> <hr/> <hr/> <hr/> <hr/>		

E. LAND USE

	YES	NO	N/A
E1. Are you aware of the property being part of or subject to any subdivision homeowners' associations, or other homeowners' associations?	<input checked="" type="checkbox"/>	<input type="checkbox"/>	<input type="checkbox"/>
E2. If the property is not a condominium unit, are you aware of common areas associated with the property that are co-owned with others?	<input type="checkbox"/>	<input checked="" type="checkbox"/>	<input type="checkbox"/>
E3. Are you aware of the property or any portion of the property being located in a floodplain, wetland, or shoreland zoning area under local, state or federal law?	<input type="checkbox"/>	<input checked="" type="checkbox"/>	<input type="checkbox"/>
E4. Are you aware of any zoning code violations with respect to the property?	<input type="checkbox"/>	<input checked="" type="checkbox"/>	<input type="checkbox"/>
E5. Are you aware of nonconforming uses of the property? A nonconforming use is a use of land, a dwelling, or a building that existed lawfully before the current zoning ordinance was enacted or amended, but that does not conform to the use restrictions in the current ordinance.	<input type="checkbox"/>	<input checked="" type="checkbox"/>	<input type="checkbox"/>
E6. Are you aware of conservation easements on the property? A conservation easement is a legal agreement in which a property owner conveys some of the rights associated with ownership of his or her property to an easement holder such as a governmental unit or a qualified nonprofit organization to protect the natural habitat of fish, wildlife, or plants or a similar ecosystem, preserve areas for outdoor recreation or education, or for similar purposes.	<input type="checkbox"/>	<input checked="" type="checkbox"/>	<input type="checkbox"/>
E7. Are you aware of restrictive covenants or deed restrictions on the property?	<input checked="" type="checkbox"/>	<input type="checkbox"/>	<input type="checkbox"/>
E8. Other than public rights of ways, are you aware of nonowners having rights to use part of the property, including, but not limited to, private rights-of-way and easements other than recorded utility easements?	<input type="checkbox"/>	<input checked="" type="checkbox"/>	<input type="checkbox"/>
E8a. Are you aware of any private road agreements or shared driveway agreements relating to the property?	<input type="checkbox"/>	<input checked="" type="checkbox"/>	<input type="checkbox"/>
E9. Are you aware of the property being subject to a mitigation plan required under administrative rules of the Wisconsin Department of Natural Resources related to county shoreland zoning ordinances, which obligates the owner of the property to establish or maintain certain measures related to shoreland conditions and which is enforceable by the county?	<input type="checkbox"/>	<input checked="" type="checkbox"/>	<input type="checkbox"/>
E10. The use value assessment system values agricultural land based on the income that would be generated from its rental for agricultural use rather than its fair market value. When a person converts agricultural land to a non agricultural use (e.g., residential or commercial development), that person may owe a conversion charge. For more information visit https://www.revenue.wi.gov/Pages/FAQS/slf-useassmt.aspx or (608) 266-2486.			
a. Are you aware of all or part of the property having been assessed as agricultural land under Wis. Stat. s. 70.32 (2r) (use value assessment)?	<input type="checkbox"/>	<input checked="" type="checkbox"/>	<input type="checkbox"/>
b. Are you aware of the property having been assessed a use-value assessment conversion charge relating to this property? (Wis. Stat. s. 74.485 (2))	<input checked="" type="checkbox"/>	<input type="checkbox"/>	<input type="checkbox"/>

YES NO N/A

- c. Are you aware of the payment of a use-value assessment conversion charge having been deferred relating to this property? (Wis. Stat. s. 74.485 (4)) YES NO N/A
- E11. Is all or part of the property subject to or in violation of a farmland preservation agreement? YES NO N/A
 Early termination of a farmland preservation agreement or removal of land from such an agreement can trigger payment of a conversion fee equal to 3 times the class 1 "use value" of the land. Visit https://datcp.wi.gov/Pages/Programs_Services/FPAgreements.aspx for more information.
- E12. Is all or part of the property subject to, enrolled in, or in violation of the Forest Crop Law, Managed Forest Law, the Conservation Reserve Program, or a comparable program? YES NO N/A
- E13. Are you aware of a dam that is totally or partially located on the property or that an ownership in a dam that is not located on the property will be transferred with the property because it is owned collectively by members of a homeowners' association, lake district, or similar group? (If "yes," contact the Wisconsin Department of Natural Resources to find out if dam transfer requirements or agency orders apply.) YES NO N/A
- E14. Are you aware of boundary or lot line disputes, encroachments, or encumbrances (including a joint driveway) affecting the property? YES NO N/A
 Encroachments often involve some type of physical object belonging to one person but partially located on or overlapping on land belonging to another; such as, without limitation, fences, houses, garages, driveways, gardens, and landscaping. Encumbrances include, without limitation, a right or claim of another to a portion of the property or to the use of the property such as a joint driveway, liens, and licenses.
- E15. Are you aware there is not legal access to the property? YES NO N/A
- E16. Are you aware of a pier attached to the property that is not in compliance with state or local pier regulations? See <http://dnr.wi.gov/topic/waterways> for more information. YES NO N/A
- E17. Are you aware of a written agreement affecting riparian rights related to the property? YES NO N/A
- E18. Are you aware that the property abuts the bed of a navigable waterway that is owned by a hydroelectric operator? YES NO N/A
 Under Wis. Stat. s. 30.132, the owner of a property abutting the bed of a navigable waterway that is owned by a hydroelectric operator, as defined in s. 30.132 (1) (b), may be required to ask the permission of the hydroelectric operator to place a structure on the bed of the waterway.
- E19. Are you aware of one or more burial sites on the property? (For information regarding the presence, preservation, and potential disturbance of burial sites, contact the Wisconsin Historical Society at 800-342-7834 or www.wihist.org/burial-information). YES NO N/A
- E20. Are you aware of archeological artifacts, mineral rights, orchards, or endangered species on the property? YES NO N/A
- E21. Are you aware of existing or abandoned manure storage facilities located on the property? YES NO N/A
- E22. Are you aware that all or part of the property is enrolled in the managed forest land program? YES NO N/A
 The managed forest land program is a landowner incentive program that encourages sustainable forestry on private woodlands by exempting the landowner from the payment of property taxes in exchange for the payment of a lower acreage share payment and compliance with certain conservation practices. Orders designating lands as managed forest lands remain in effect for 25 or 50 years. When ownership of land enrolled in the managed forest land program changes, the new owner must sign and file a report of the change of ownership on a form provided by the Wisconsin Department of Natural Resources (DNR) and pay a fee. By filing this form, the new owner agrees to comply with the management plan for the land and the managed forest land program rules. The DNR Division of Forestry monitors forest management plan compliance. Changes that a landowner makes to property that is subject to an order designating it as managed forest land, or to its use, may jeopardize benefits under the program or cause the property to be withdrawn from the program and may result in the assessment of penalties. For more information, call your local DNR forester or visit <http://dnr.wi.gov/topic/forestry.html>

E23. Explanation of "yes" responses

F. ADDITIONAL INFORMATION

	YES	NO	N/A
F1. Are you aware of high voltage electric (100 kilo volts or greater) or steel natural gas transmission lines located on, but not directly serving, the property?	<input type="checkbox"/>	<input checked="" type="checkbox"/>	<input type="checkbox"/>
F1a. Are you aware if there is internet service available to property? If so, which provider? _____	<input type="checkbox"/>	<input checked="" type="checkbox"/>	<input type="checkbox"/>
F2. Are you aware of flooding, standing water, drainage problems, or other water problems on or affecting the property?	<input type="checkbox"/>	<input checked="" type="checkbox"/>	<input type="checkbox"/>
F3. Are you aware of material damage from fire, wind, flood, earthquake, expansive soil, erosion, or landslide?	<input type="checkbox"/>	<input checked="" type="checkbox"/>	<input type="checkbox"/>
F4. Are you aware of significant odor, noise, water diversion, water intrusion, or other irritants emanating from neighboring property?	<input type="checkbox"/>	<input checked="" type="checkbox"/>	<input type="checkbox"/>
F5. Are you aware of significant crop damage from disease, insects, soil contamination, wildlife, or other causes; diseased or dying trees or shrubs; or substantial injuries or disease in livestock on the property or neighboring property?	<input type="checkbox"/>	<input checked="" type="checkbox"/>	<input type="checkbox"/>
F6. Utility Connections. Are you aware that the property is connected to the following utilities on the property or at the lot line? (If "yes," indicate where the utility is located.)	<input checked="" type="checkbox"/>	<input type="checkbox"/>	<input type="checkbox"/>
a. Electricity _____	<input checked="" type="checkbox"/>	<input type="checkbox"/>	<input type="checkbox"/>
b. Municipal water _____	<input checked="" type="checkbox"/>	<input checked="" type="checkbox"/>	<input type="checkbox"/>
c. Telephone _____ <i>see below</i>	<input checked="" type="checkbox"/>	<input type="checkbox"/>	<input type="checkbox"/>
d. Cable television _____	<input checked="" type="checkbox"/>	<input type="checkbox"/>	<input type="checkbox"/>
e. Natural gas _____	<input checked="" type="checkbox"/>	<input type="checkbox"/>	<input type="checkbox"/>
f. Municipal sewer _____ <i>see attached perc test</i>	<input checked="" type="checkbox"/>	<input checked="" type="checkbox"/>	<input type="checkbox"/>
F7. Are you aware of any agreements that bind subsequent owners of the property, such as a lease agreement or an extension of credit from an electric cooperative?	<input type="checkbox"/>	<input checked="" type="checkbox"/>	<input type="checkbox"/>
F7a. Are you aware of any right of first refusal, recorded or not, on all or any portion of the property?	<input type="checkbox"/>	<input checked="" type="checkbox"/>	<input type="checkbox"/>
F8. Are you aware of other defects affecting the property? Other defects may include items such as animal, reptile, or insect infestation, including infestation impacting trees; drainage easement or grading problems; excessive sliding; or any other defect or material condition.	<input type="checkbox"/>	<input checked="" type="checkbox"/>	<input type="checkbox"/>
F9. Are you aware of a government agency, court order, or federal, state, or local regulations requiring repair, alteration, or correction of an existing condition?	<input type="checkbox"/>	<input checked="" type="checkbox"/>	<input type="checkbox"/>
F10. Is the owner a foreign person, as defined in 26 USC 1445 (f)? (E.g. a nonresident alien individual, foreign corporation, foreign partnership, foreign trust, or foreign estate.) Section 1445 of the Internal Revenue Code (26 USC 1445), also known as the Foreign Investment In Real Property Tax Act or FIRPTA, provides that a transferee (buyer) of a U.S. real property interest must be notified in writing and must withhold tax if the transferor (seller) is a foreign person, unless an exception under FIRPTA applies to the transfer.	<input type="checkbox"/>	<input checked="" type="checkbox"/>	<input type="checkbox"/>
F11. The owner has owned the property for _____ years.			
F12. Explanation of "yes" responses _____			
<p><i>F1a & f6d - Spectrum is available for homes at 3182-3198 Castleton Crossing it is not currently to this property, but a neighboring property.</i></p>			

Notice: You may obtain information about the sex offender registry and persons registered with the registry by contacting the Wisconsin Department of Corrections at <http://www.doc.wi.gov> or by phone at 608-240-5830.

OWNER'S CERTIFICATION

NOTE: Wisconsin Statute section 709.035 requires owners who, prior to acceptance of a purchase contract or an option to purchase, obtain information that would change a response on this report to submit a complete amended report or an amendment to the previously completed report to the prospective buyer within 10 days of acceptance.

The owner certifies that the information in this report is true and correct to the best of the owner's knowledge as of the date on which the owner signs this report.

Owner Michael Koch Date 8-12-24
 Owner Carla Koch Date 8-12-24
 Owner _____ Date _____

CERTIFICATION BY PERSON SUPPLYING INFORMATION

A person other than the owner certifies that the person supplied information on which the owner relied for this report and that the information is true and correct to the best of the person's knowledge as of the date on which the person signs this report.

Person _____ Items _____ Date _____
 Person _____ Items _____ Date _____
 Person _____ Items _____ Date _____

BUYER'S ACKNOWLEDGEMENT

The prospective buyer acknowledges that technical knowledge such as that acquired by professional inspectors may be required to detect certain defects such as the presence of asbestos, building code violations, and floodplain status.

I acknowledge receipt of a copy of this statement.

Prospective buyer _____ Date _____
 Prospective buyer _____ Date _____
 Prospective buyer _____ Date _____

Information appearing in italics is supplemental in nature and is not required pursuant to Section 709.03 of the Wisconsin Statutes.

Division of Industry Services

in accordance with SPS 385, Wis. Adm. Code

Attach complete site plan on paper not less than 8 1/2 x 11" in size. Plan must include, but not limited to: vertical and horizontal reference point (BM), direction and % slope, scale or dimensions, north arrow, location & distance to nearest road.

County	DANE
Parcel I.D.	196/0910-134-9275-1
Reviewed by	Date

Please print all information

Personal information you provide may be used for secondary purposes (Privacy Law, s.15.04(1)(m)).

Property Owner WINDSOR QUARRY LLC		Property Location NW 1/4, SE 1/4, S 13, T 9 N, R 10 E	
Property Owner's Mailing Address 4607 OAK SPRINGS CIR		Lot # 2	Subd. Name or CSM# PROPOSED CSM
City DE FOREST WI	State WI	Zip Code 53532	Phone Number
<input type="checkbox"/> City	<input checked="" type="checkbox"/> City	<input checked="" type="checkbox"/> Village	Nearest Road CASTLETON CROSSING

New Construction Use: Residential/No. bedrooms 5 Code derived design flow rate: 750 GPD

Replacement Public or commercial- Describe: _____

Parent Material: LOESS, GLACIAL TILL Flood Plain elevation if applicable Unknown

General comments and recommendations:
0.4 GPD/SQ.FT. LOADING RATE BETWEEN BORINGS 1, 2, AND 4

Boring Boring Pit Ground surface elev. 955.07' Depth to limiting factor N/A

Horizon	Depth inches	Dominant Color Munsell	Redox Description Qu. Sz. Cont. Color	Texture	Structure Gr. Sz. Sh.	Consistence (Moist)	Roots	Boundary	Soil Application Rate GPD/ft ²	
									*Eff#1	*Eff#2
Ap	0-9	10YR3/2		sil	2mgr	fr	2f	as	0.6	0.8
Bt1	9-29	10YR4/4		sicl	2fsbk	fi	1f	cs	0.4	0.6
Bt2	29-36	10YR4/4		sicl	1fsbk	fi	1f	cs	0.2	0.3
BC	36-40	10YR4/4		scl	1msbk	fi	1f	cw	0.2	0.3
C	40-132	10YR5/4		gr sl	1msbk	vfr			0.4	0.7

Boring Boring Pit Ground surface elev. 951.48' Depth to limiting factor N/A

Horizon	Depth inches	Dominant Color Munsell	Redox Description Qu. Sz. Cont. Color	Texture	Structure Gr. Sz. Sh.	Consistence (Moist)	Roots	Boundary	Soil Application Rate GPD/ft ²	
									*Eff#1	*Eff#2
Ap	0-10	10YR3/2		sil	2mgr	fr	2f	as	0.6	0.8
Bt1	10-17	10YR4/4		sicl	2fsbk	fi	1f	cs	0.4	0.6
Bt2	17-30	10YR4/4		sicl	1fsbk	fi	1f	cw	0.2	0.3
C	30-108	10YR5/4		gr sl	1msbk	vfr			0.4	0.7

*Effluent #1 = BOD₅ > 30 ≤ 220 mg/L and TSS > 30 ≤ 150 mg/L

*Effluent #2 = BOD₅ ≤ 30 mg/L and TSS ≤ 30 mg/L

CST Name Address	CLAY VANDERLEEST N7803 TOPPE RD WATERLOO, WI 53594	Signature: 	CST Number 1190689 Telephone No. (608) 509-2855
Date Evaluation Conducted: 2/13/2023			

Boring Boring
 Pit

23 Ground surface elev. 951.55' Depth to limiting factor 37"

Horizon	Depth inches	Dominant Color Munsell	Redox Description Qu. Sz. Cont. Color	Texture	Structure Gr.Sz.Sh.	Consistence (Moist)	Roots	Boundary	Soil Application Rate GPD/ft ²	
									*Eff#1	*Eff#2
Ap	0-12	10YR3/2		sil	2mgr	fr	2f	as	0.6	0.8
Bt1	12-24	10YR4/4		sicl	2fsbk	fi	1f	cs	0.4	0.6
Bt2	24-37	10YR4/4		sicl	1fsbk	fi	1f	cs	0.2	0.3
C1	37-65	10YR4/4	c2d10YR6/6 6/2	sicl	0mass	fi	1f	cw	0	0
C2	65-116	10YR5/4		gr sl	1msbk	vfr			0.4	0.7

Boring Boring
 Pit

24 Ground surface elev. 951.15' Depth to limiting factor N/A

Horizon	Depth inches	Dominant Color Munsell	Redox Description Qu. Sz. Cont. Color	Texture	Structure Gr.Sz.Sh.	Consistence (Moist)	Roots	Boundary	Soil Application Rate GPD/ft ²	
									*Eff#1	*Eff#2
Ap	0-12	10YR3/2		sil	2mgr	fr	2f	as	0.6	0.8
Bt1	12-28	10YR4/4		sicl	2fsbk	fi	1f	cs	0.4	0.6
Bt2	28-42	10YR4/4		sicl	1fsbk	fi	1f	cs	0.2	0.3
BC	42-50	10YR4/4		scl	1msbk	fi	1f	cw	0.2	0.3
C	50-100	10YR5/4		gr sl	1msbk	vfr			0.4	0.7

Boring Boring
 Pit

Ground surface elev. Depth to limiting factor

Horizon	Depth inches	Dominant Color Munsell	Redox Description Qu. Sz. Cont. Color	Texture	Structure Gr.Sz.Sh.	Consistence (Moist)	Roots	Boundary	Soil Application Rate GPD/ft ²	
									*Eff#1	*Eff#2

*Effluent #1 = BOD₅ > 30 ≤ 220 mg/L and TSS > 30 ≤ 150 mg/L

*Effluent #2 = BOD₅ ≤ 30 mg/L and TSS ≤ 30 mg/L

WINDSOR QUARRY LLC

PAGE 3 OF 3

APPROX. LOT LINE

LOT 2, PROPOSED CSM
2.25 ACRES

PROPOSED DRAINFIELD
5 - 6' x 62.5' CELLS

CELL NO.	BOTTOM ELEV
1	949.7'
2	949.3'
3	948.8'
4	948.3'
5	947.8'

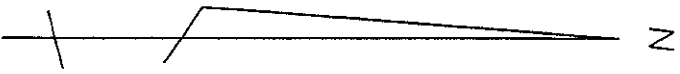

APPROX. PROPOSED LOT LINE

APPROX.
PROPOSED
5 BR.
HOUSE

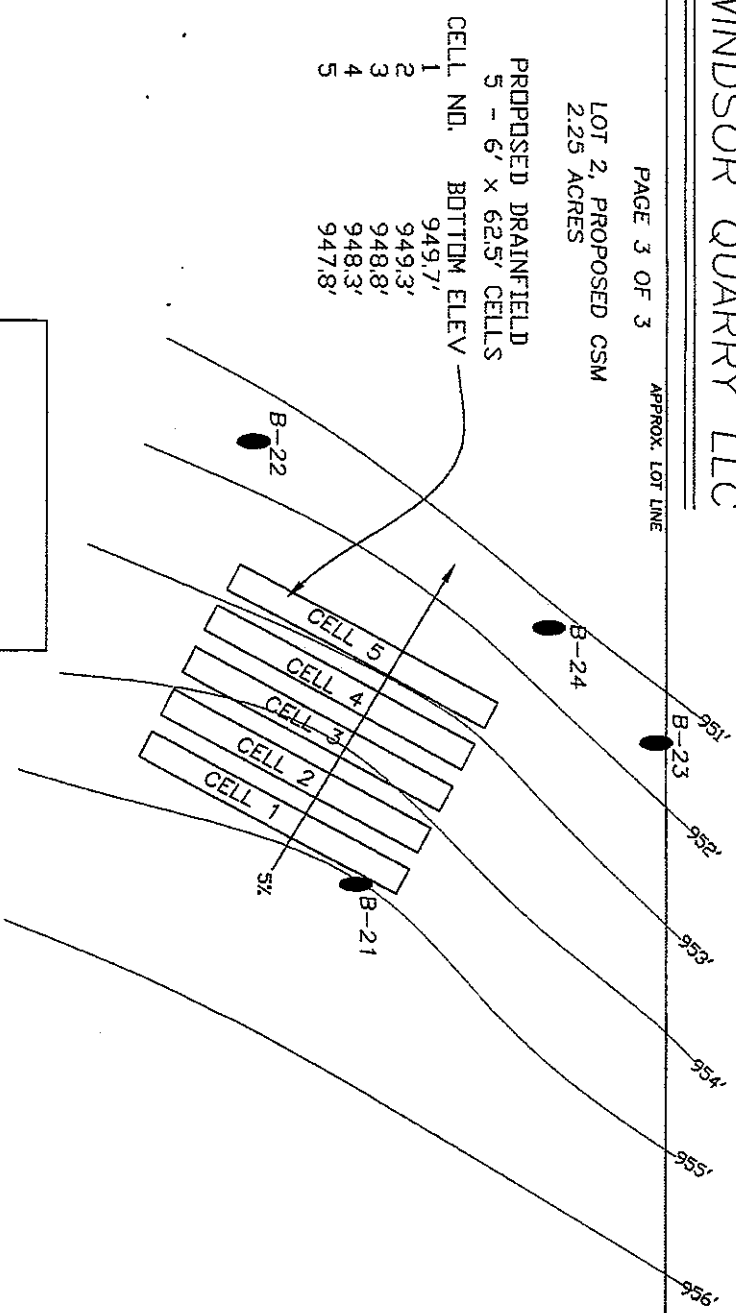

APPROX. PROPOSED LOT LINE

Scale: 1" = 40'

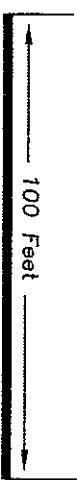

- * Elevations are for Soil Test Use Only
- * This is Not a Survey
- * Property Lines Per Owner or County GIS Website
- * Property Lines Need to be Identified Prior to Installation

LOCATION MAP
1" = 400'

PROPOSED
DRAINFIELD

PROPOSED
DRAINFIELD

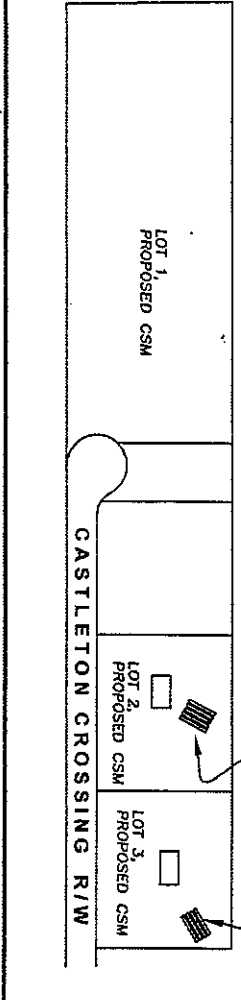

CASTLETON CROSSING R/W

BM = TOP OF
ELECTRICAL BOX,
IN CENTER
ELEV. = 956.7'